

**4.75 IN/120.65MM  
 TORPEDO DIA.**

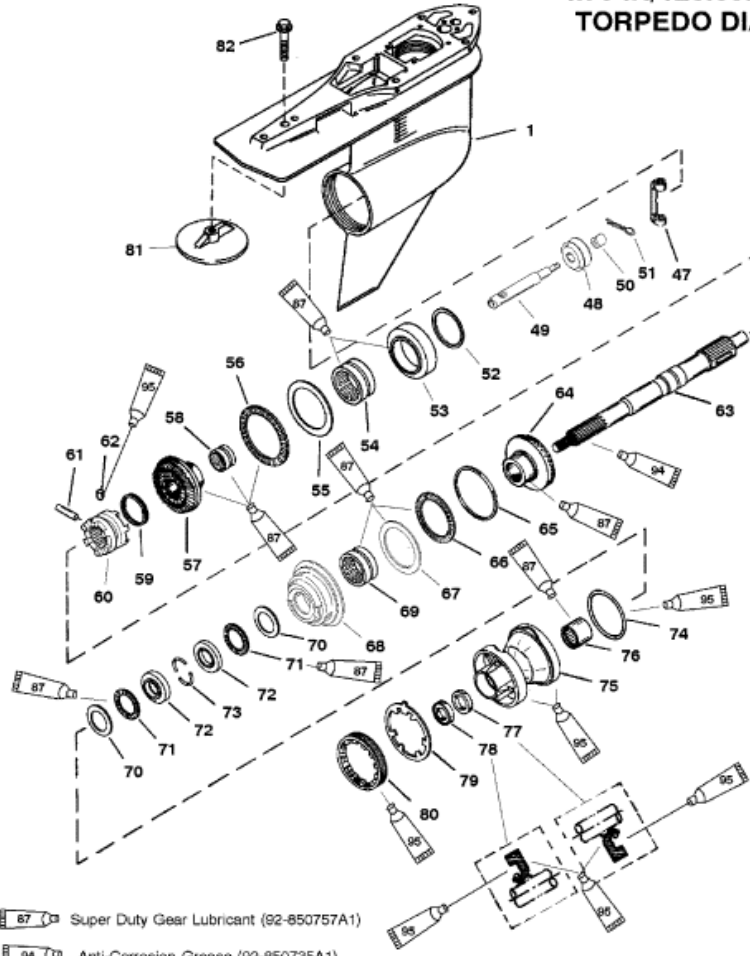

Parts List						
Ref	Class	Part	Description	Qty	Comment	Footnote
1	1623	859399T18	GEAR HOUSING	1	(BASIC)	
47		823903	SHIFT CRANK	1		
48		19755T 7	SHIFT SPOOL KIT	1		
49		NSS	SPOOL	1		
50		NSS	SLEEVE	1		
51		NSS	COTTER PIN	1		
52	15	44491A 1	SHIM	AR		
53		828830A 2	BEARING ADAPTOR ASSEMBLY	1		
54	31	814653T	ROLLER BEARING	1		
55	12	815481	THRUST WASHER	1		
56	31	815480	THRUST BEARING	1		
57	43	828696T 2	REVERSE GEAR	1	(12/21)	
58	31	15844	ROLLER BEARING	1		
59	24	30893	SPRING	1		
60	52	859340T	SLIDING CLUTCH	1		
61	17	30632	CROSS PIN	1		
62	17	828356	DETENT PIN	1		
63	44	824111	PROPELLER SHAFT	1		
64	43	828695A 1	FORWARD GEAR (INCLUDES PIN	1	(12/21)	
65	23	17615 14	SPACER SHIM .206 IN.	AR		
65	23	17615 15	SPACER SHIM .208 IN.	AR		
65	23	17615 16	SPACER SHIM .210 IN.	AR		
65	23	17615 17	SPACER SHIM .212 IN.	AR		
65	23	17615 18	SPACER SHIM .214 IN.	AR		
65	23	17615 19	SPACER SHIM .216 IN.	AR		
65	23	17615 20	SPACER SHIM .218 IN.	AR		
65	23	17615 21	SPACER SHIM .220 IN.	AR		
65	23	17615 22	SPACER SHIM .222 IN.	AR		
65	23	17615 23	SPACER SHIM .224 IN.	AR		
65	23	17615 24	SPACER SHIM .226 IN.	AR		
65	23	17615 25	SPACER SHIM .228 IN.	AR		
65	23	17615 26	SPACER SHIM .230 IN.	AR		
66	31	815480	ROLLER BEARING	1		
67	12	815481	THRUST RING	1		
68		828831A 3	BEARING ADAPTOR ASSEMBLY	1		
69	31	814653T	ROLLER BEARING	1		
70	12	18448	THRUST WASHER	2		
71	31	15842	THRUST BEARING	2		
72		818291 1	THRUST RACE	2		
73		814605	KEEPER	2		
74	25	21524	O-RING	1		15

- 87 Super Duty Gear Lubricant (92-850757A1)
- 94 Anti-Corrosion Grease (92-850735A1)
- 95 2-4-C w/Teflon (92-850736A1)